

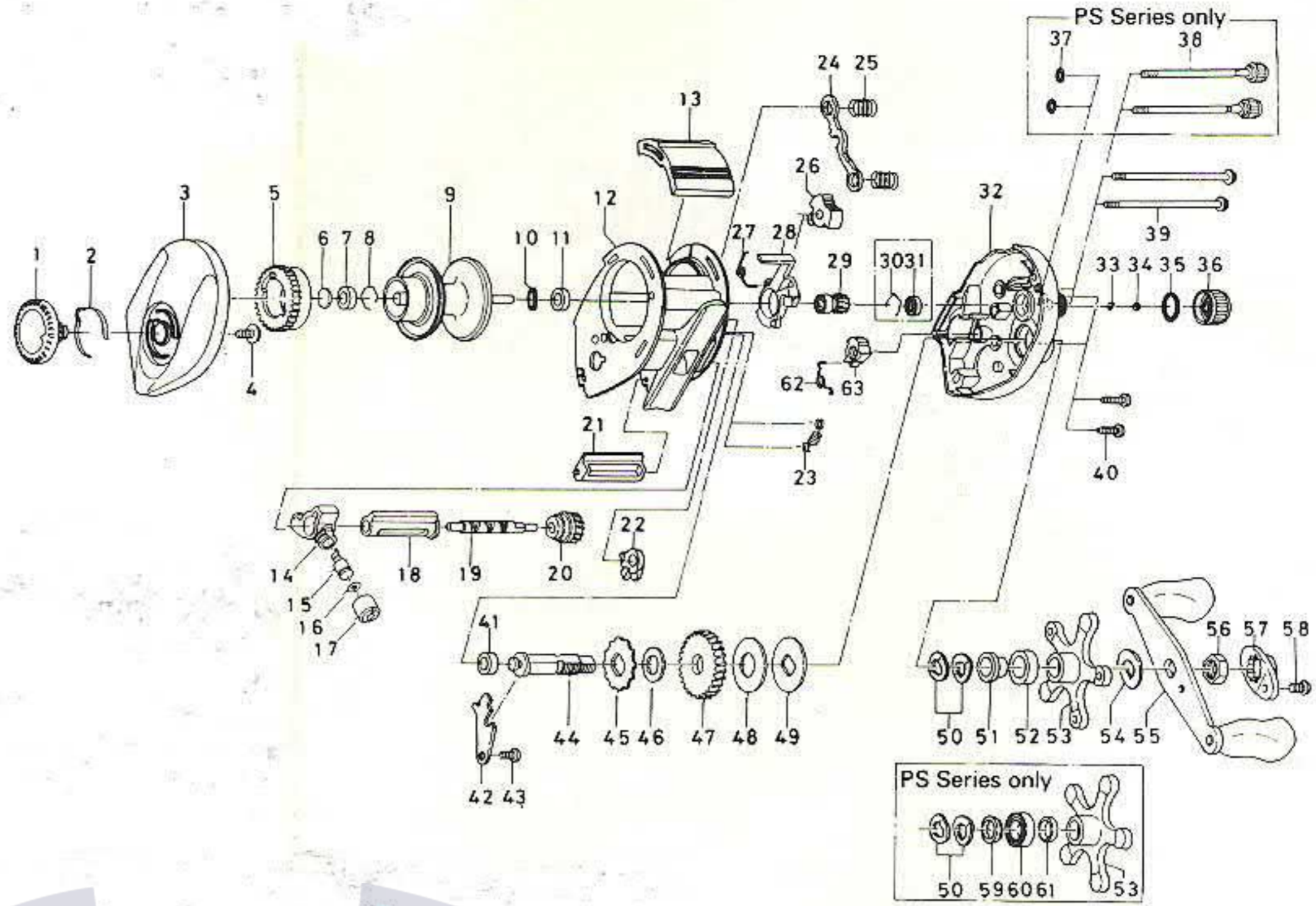

Daiwa
COMMITTED TO TOTAL QUALITY

BAITCASTING REEL

BW2,
EL2, EL2C,
PS2-2B,
PS2-5B



BW2

Key No.

Parts No.

Parts Name

Designation des pieces

| | |
|----|------------|
| 1 | 6-F05-5801 |
| 2 | 6-F03-2401 |
| 3 | 6-F05-4501 |
| 4 | 6-B84-2102 |
| 5 | 6-E23-9501 |
| 6 | 6-375-7400 |
| 7 | 6-B55-0301 |
| 8 | 6-B42-1601 |
| 9 | 6-F05-4901 |
| 10 | 6-F12-0701 |
| 11 | 6-E35-1501 |
| 12 | 6-F05-3701 |
| 13 | 6-F05-4001 |
| 14 | 6-E16-6301 |
| 15 | 6-121-4212 |
| 16 | 6-375-4100 |
| 17 | 6-342-4801 |
| 18 | 6-E31-2001 |
| 19 | 6-E45-1201 |
| 20 | 6-F08-5201 |
| 21 | 6-F05-3901 |
| 22 | 6-E23-8001 |
| 23 | 6-E16-5801 |
| 24 | 6-E23-7701 |
| 25 | 6-E16-7101 |
| 26 | 6-E24-9101 |
| 27 | 6-E24-9001 |
| 28 | 6-E23-7401 |
| 29 | 6-F26-4601 |
| 32 | 6-F05-4217 |
| 33 | 6-E16-9201 |
| 34 | 6-E17-0501 |
| 35 | 6-171-5201 |
| 36 | 6-E23-8401 |
| 39 | 6-E28-4901 |
| 40 | 6-E33-0401 |
| 41 | 6-B55-0301 |
| 42 | 6-E23-7601 |
| 43 | 6-B83-4402 |
| 44 | 6-E23-7501 |
| 45 | 6-E32-7701 |
| 46 | 6-375-7103 |
| 47 | 6-F12-6701 |
| 48 | 6-B36-0202 |
| 49 | 6-B36-0301 |
| 50 | 6-150-8901 |
| 51 | 6-E32-6401 |
| 52 | 6-E34-6801 |
| 53 | 6-E23-8701 |
| 54 | 6-150-9001 |
| 55 | 6-E30-5201 |
| 56 | 6-B43-3601 |
| 57 | 6-F05-4401 |
| 58 | 6-351-1801 |
| 62 | 6-F12-0501 |
| 63 | 6-E30-9501 |

| |
|-----------------------------|
| Brake adjusting knob |
| Brake click spring |
| Left side plate |
| Brake adjusting knob screw |
| Magnet holder |
| Spacer A |
| Bushing A |
| Bearing retainer A |
| Spool assembly |
| Ball bearing retaining ring |
| Bushing B |
| Frame assembly |
| Clutch lever |
| Line guide |
| Line guide pawl |
| Line guide washer |
| Pawl cap |
| Level wind guard |
| Worm shaft |
| Worm shaft gear |
| Line guard |
| Anti-reverse pawl |
| Clutch trip plate spring |
| Yoke |
| Yoke spring |
| Flipping/casting selector |
| Clutch cam spring |
| Clutch cam |
| Pinion gear |
| Right side plate |
| Spool adjusting cap metal |
| Spacer B |
| "O" ring A |
| Cast control cap |
| Right side plate screw A |
| Set plate screw |
| Bushing A |
| Drive shaft retainer |
| Drive shaft retainer screw |
| Drive shaft |
| Anti-reverse ratchet |
| Drive shaft washer |
| Drive gear |
| Drag washer |
| Key washer |
| Drag spring washer |
| Spacing sleeve A |
| Spacing sleeve B |
| Star drag |
| Friction washer |
| Handle assembly |
| Handle nut |
| Handle nut plate |
| Handle nut plate screw |
| Anti-reverse lever spring |
| Anti-reverse lever |

| |
|---|
| Bouton de réglage de frein |
| Ressort de cliquet de frein |
| Flasque gauche |
| Vis de bouton de réglage de frein |
| Boitier à aimants |
| Rondelle de chapeau de réglage A |
| Palier A |
| Rondelle de retenue du roulement à billes A |
| Bobine complète |
| Anneau de roulement à billes |
| Palier B |
| Bâti |
| Levier d'embrayage |
| Guide-fil |
| Pilote de guide-fil |
| Rondelle de guide-fil |
| Chapeau de pilote |
| Protecteur de vis double filet |
| Vis double filet |
| Roue de vis double filet |
| Protège-ligne |
| Cliquet anti-retour |
| Ressort de plaque d'embrayage |
| Joug de débrayage |
| Ressort de joug |
| Selecteur Flipping/lancer |
| Ressort de came d'embrayage |
| Came d'embrayage |
| Pignon |
| Flasque droit |
| Douille de chapeau de réglage de bobine |
| Rondelle de chapeau de réglage B |
| Anneau torique A |
| Chapeau de réglage de tension |
| Vis de flasque droit A |
| Vis de platine |
| Palier A |
| Verrou d'arbre de commande |
| Vis de verrou d'arbre de commande |
| Axe de la roue de commande |
| Rochet anti-retour |
| Rondelle d'axe de roue de commande |
| Roue de commande |
| Rondelle de frein |
| Rondelle fixe |
| Rondelle du ressort de frein |
| Manchon A |
| Manchon B |
| Frein étoile |
| Rondelle de friction |
| Manivelle |
| Ecrou de manivelle |
| Plaque d'ecrou de manivelle |
| Vis de plaque d'ecrou de manivelle |
| Ressort de commande de l'anti-retour |
| Commande de l'anti-retour |

EL2 Special Parts

| | |
|----|------------|
| 1 | 6-F06-0101 |
| 3 | 6-F05-4506 |
| 11 | 6-B35-8601 |
| 12 | 6-F05-3702 |
| 21 | 6-F05-3902 |
| 32 | 6-F05-4219 |
| 53 | 6-E23-8702 |
| 55 | 6-E30-5203 |

| |
|----------------------|
| Brake adjusting knob |
| Left side plate |
| Ball bearing |
| Frame assembly |
| Line guard |
| Right side plate |
| Star drag |
| Handle assembly |

| |
|----------------------------|
| Bouton de réglage de frein |
| Flasque gauche |
| Roulement à billes |
| Bâti |
| Protège-ligne |
| Flasque droit |
| Frein étoile |
| Manivelle |

EL2C Special Parts

| | |
|----|------------|
| 1 | 6-F06-0101 |
| 3 | 6-F05-4507 |
| 11 | 6-B35-8601 |
| 12 | 6-F05-3702 |
| 20 | 6-F06-1301 |
| 21 | 6-F05-3902 |
| 29 | 6-E42-7701 |
| 32 | 6-F05-4220 |
| 47 | 6-E42-7601 |
| 48 | 6-B30-9102 |
| 49 | 6-F06-6701 |
| 53 | 6-E23-8702 |
| 55 | 6-E30-5203 |

| |
|----------------------|
| Brake adjusting knob |
| Left side plate |
| Ball bearing |
| Frame assembly |
| Worm shaft gear |
| Line guard |
| Pinion gear |
| Right side plate |
| Drive gear |
| Drag washer |
| Key washer |
| Star drag |
| Handle assembly |

| |
|----------------------------|
| Bouton de réglage de frein |
| Flasque gauche |
| Roulement à billes |
| Bâti |
| Roue de vis double filet |
| Protège-ligne |
| Pignon |
| Flasque droit |
| Roue de commande |
| Rondelle de frein |
| Rondelle fixe |
| Frein étoile |
| Manivelle |

PS2-2B Special Parts

| | |
|----|------------|
| 1 | 6-F06-0401 |
| 3 | 6-F05-4503 |
| 9 | 6-F06-0601 |
| 11 | 6-B35-8601 |
| 12 | 6-F05-3702 |
| 13 | 6-F06-0201 |
| 21 | 6-F05-3902 |
| 32 | 6-F05-4218 |
| 37 | 6-B85-3101 |
| 38 | 6-B91-1712 |

| |
|------------------------|
| Brake adjusting knob |
| Left side plate |
| Spool assembly |
| Ball bearing A |
| Frame assembly |
| Clutch lever |
| Line guard |
| Right side plate |
| "O" ring B |
| Right side plate screw |

| |
|----------------------------|
| Bouton de réglage de frein |
| Flasque gauche |
| Bobine complète |
| Roulement à billes A |
| Bâti |
| Levier d'embrayage |
| Protège-ligne |
| Flasque droit |
| Anneau torique B |
| Vis de flasque droit |